

for  
Allan Mark Angell  
Angell Hasman & Associates  
(The Angell Group)  
1555 Marine Drive  
West Vancouver, B.C.  
Tel: 604-921-1188  
Fax: 604-921-1199

PROJECT:  
# 901  
426  
Beach Crescent

DRAWING:  
All Floors

CONSULTANT:

**POINT SOURCE**  
**MEDIA**  
www.pointsourcemedia.ca  
604-839-8889

DATE: 30/01/07  
SCALE: As shown  
DRAWN: Colen Low  
CHECKED:  
COMMENTS:

NO.	DATE	DETAILS

DRAWING NO.:  
**0000054**

Main Floor Plan  
3216 sqft

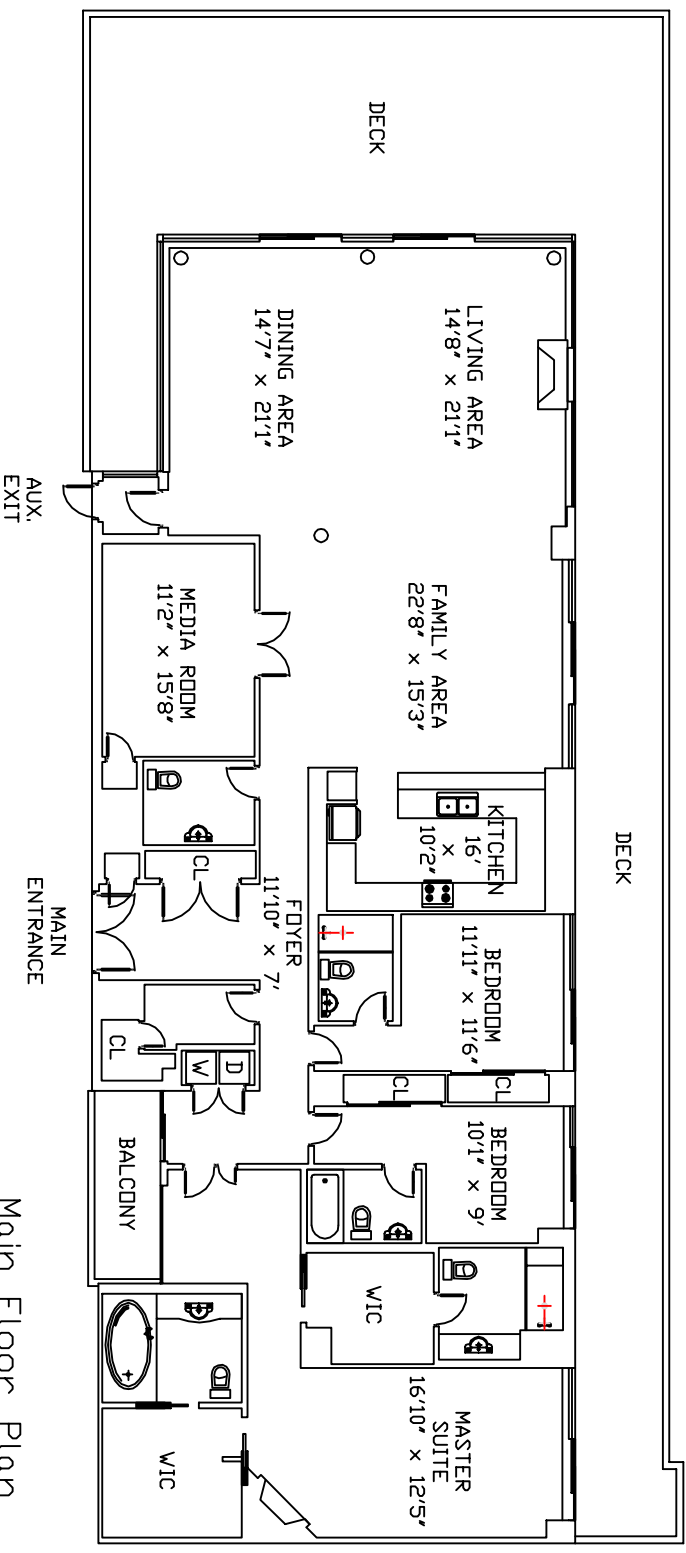

TOTAL FINISHED AREA  
3216 sqft

Finished floor area calculations are based on measurements taken from the outside surface of the exterior walls or to the center of any shared walls. Irregular room dimensions have been calculated based on the largest rectangular space accommodated by the interior surfaces of those walls. Calculations do not include porches, patios, decks, garages, carports, mechanical and electrical rooms, crawl spaces, and any other unfinished areas. All measurements are subject to errors not exceeding 2.0%.

#901 - 426 Beach Crescent - Vancouver