

for  
**Allan Mark Angell**  
Angell Harman & Associates  
(The Angell Group)

1555 Marine Drive  
West Vancouver, B.C.  
Tel: 604-921-1188  
Fax: 604-921-1199

PROJECT:  
**640**  
King Georges Way

DRAWING:  
All Floors

CONSULTANT:

**pointsourcemedia**  
www.pointsourcemedia.ca  
604-839-8889

DATE:	20/01/08
SCALE:	As shown
DRAWN:	Colin Low
CHECKED:	
COMMENTS:	

NO.	DATE	DETAILS

DRAWING NO.:  
**0000103**

Finished Area	Above Grade: 2945 sqft
	Below Grade: 0 sqft
Unfinished Area	Above Grade: 23 sqft
	Below Grade: 0 sqft

Scale Reference  
10 ft

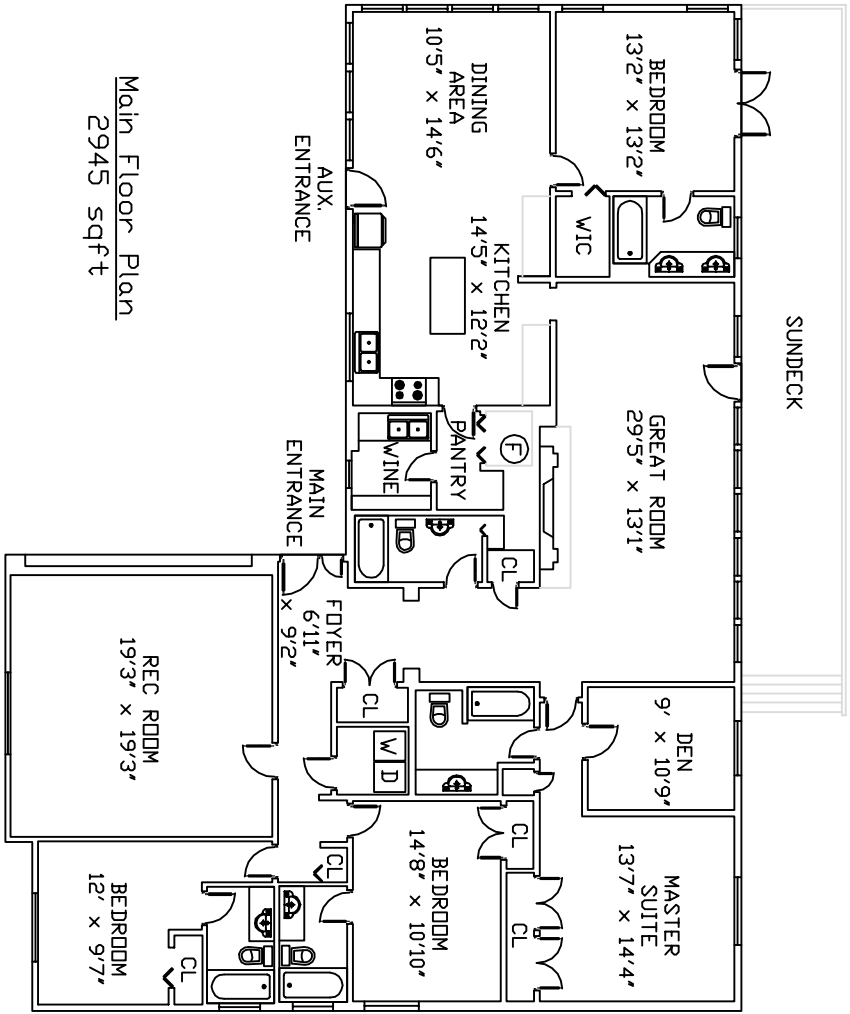

Main Floor Plan  
2945 sqft

**TOTAL FINISHED AREA**  
2945 sqft

This property was measured using the ANSI Z765 standard. Total floor area calculations are based on measurements taken from the outside surface of the exterior walls. Walls that could not be measured directly have been extrapolated from interior measurements. Calculations do not include porches, patios, decks, garages, carports, mechanical and electrical rooms, crawl spaces, and any other unfinished areas. Individual room dimensions have been calculated based on the largest rectangular space accommodated by the interior surfaces of those walls. For more information, please consult the ANSI Z765 standard. All measurements are subject to errors not exceeding 20%.

640 King Georges Way - West Vancouver